



Trailsync

Trailsync Cable replacement

Trailsync

Trailsync Cable replacement

Contents

1.	Tools necessary	3
2.	Trailsync Seatpost to Shock cable replacement	4
3.	Trailsync Function Test	9
4.	Remote to Seatpost cable replacement	10

1. Tools necessary:

Work Stand:



Shifter Cable and Cable Housing:



Grease:



Allen Keys:



Torque Wrench:



Cable Cutter:



20 – 30 Minutes



Trailsync

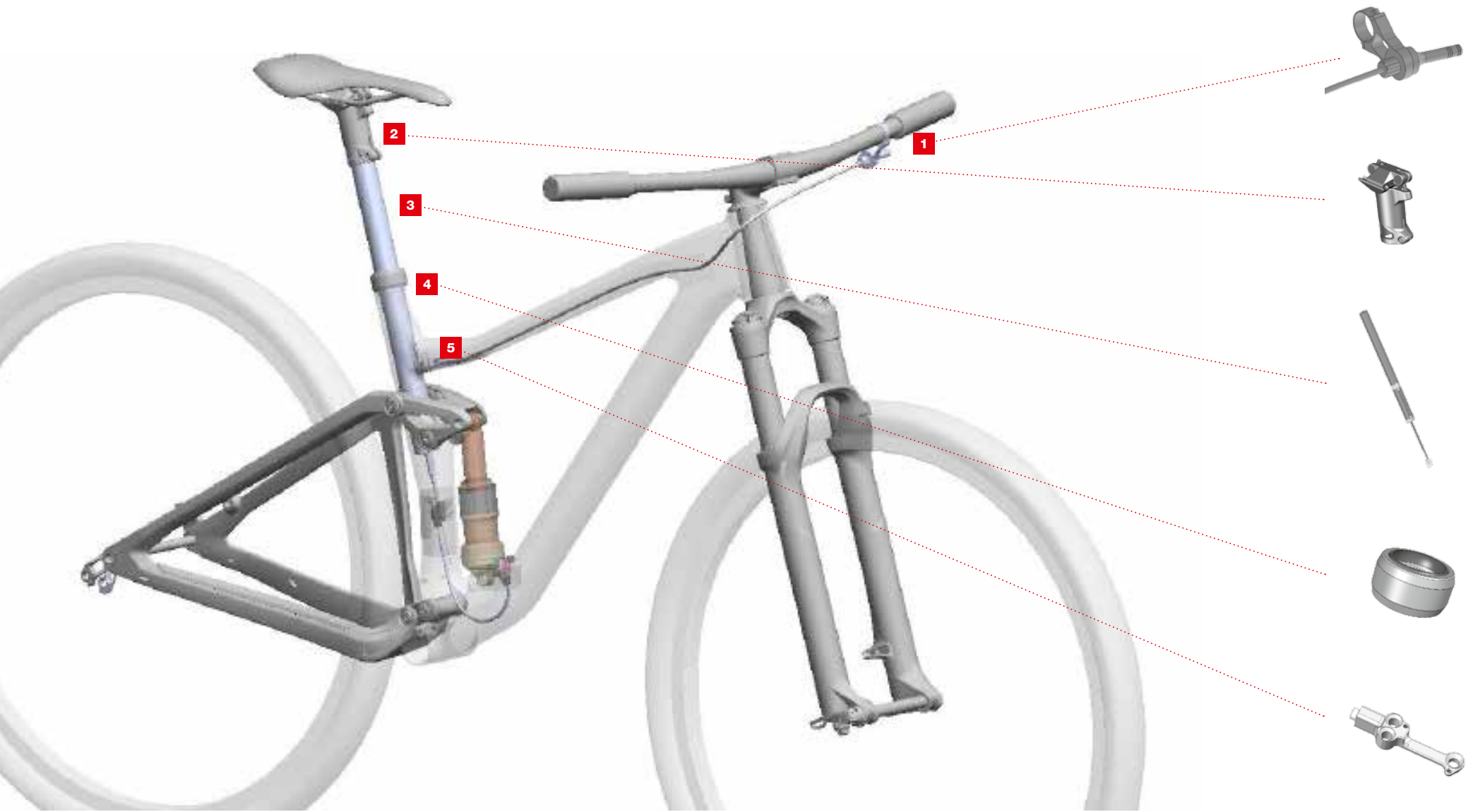

2. Trailsync Seatpost to Shock cable replacement



1 Unscrew the M5 screw of the seatpost head.

2 Remove the seatpost head from the Trailsync seatpost; it's not necessary to remove the saddle.



3 Lower the seatpost and lock it in the bottom position.

4 Loosen the screw on the shock.

Warning:
Release all air out of the air chamber!



5 Loosen the upper and lower shock screws.

6 Remove the Trailsync cable connected that is connected to the shock.

Tipp:
Use a spoke to grab the derailleur cable.



7 Slide a new shifter cable through the cable guide.

Tipp:
Bend the derailleur cable slightly for easy installation.

8 Remove the shock.

9 Remove the old cable housing.

10 Cut a new casing to the length of 220mm.



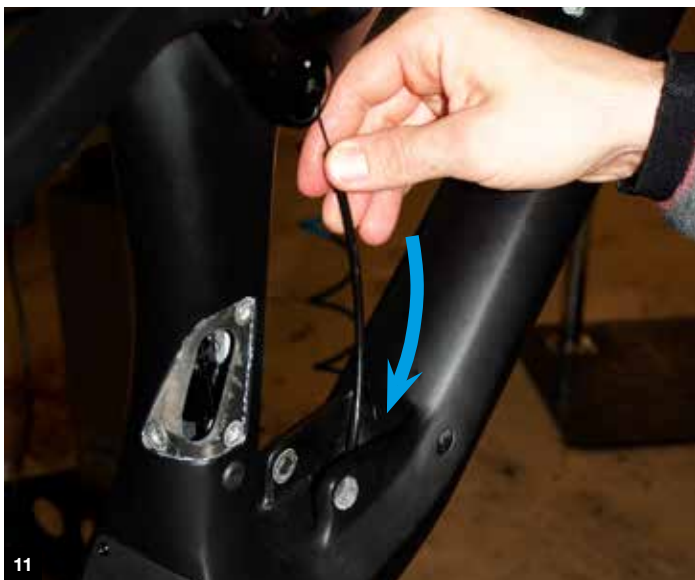

11 Install the cable housing (including end caps) over the cable that comes from the slider.

12 Be sure to fit the cable housing into the seatpost slider.

13 Fit the cable housing in the cable stop of the rear shock.

14 Attach the cable to the shock's remote pulley. Use a plier to tighten the cable.

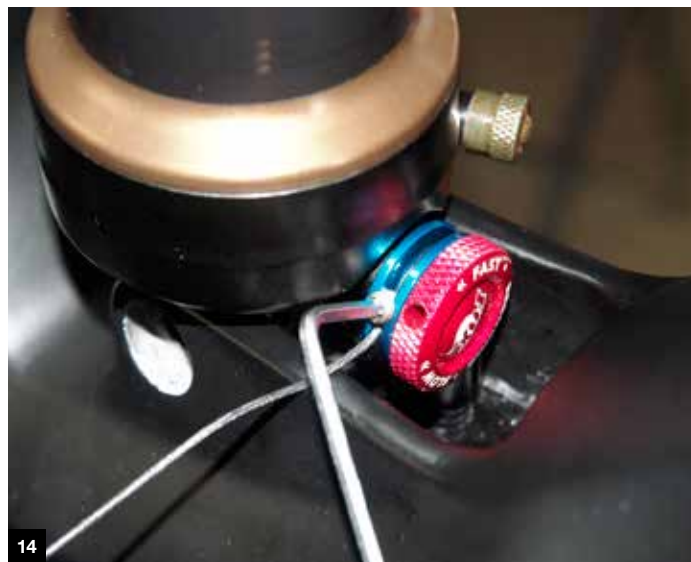

Notice:
Make sure the seatpost is in the lower position.

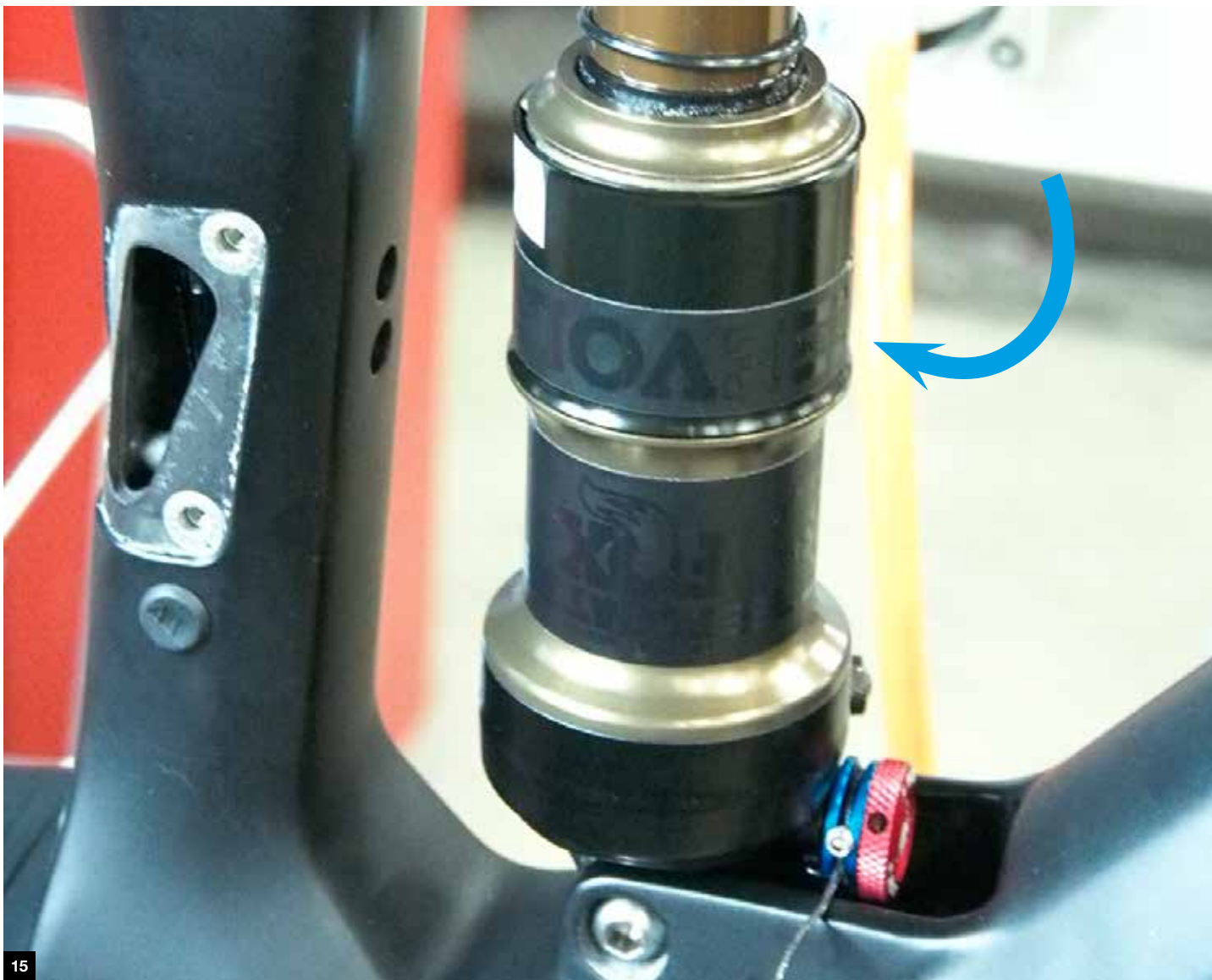

15

15 Make sure the seatpost is in the lower position.

Proceed to re-Install shock in the frame.

3. Trailsync Function Test



Center and Bottom position of the Trailsync seatpost:

Shock mode: Open

When in open mode the remote pulley rests on the end stop of the shock.

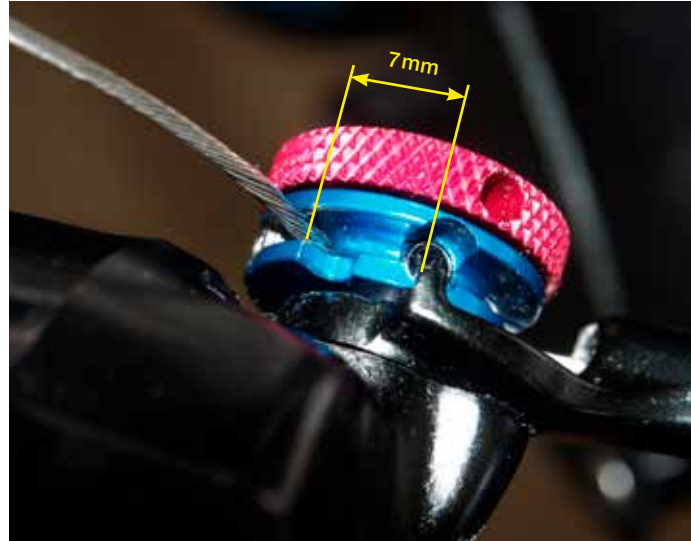

Top position of the Trailsync seatpost:

Shock mode: Firm
(commonly known as Trail)

In Firm mode, the remote pulley rests 7 mm away from the end stop of the shock.

4. Trailsync Remote to Seatpost cable replacement

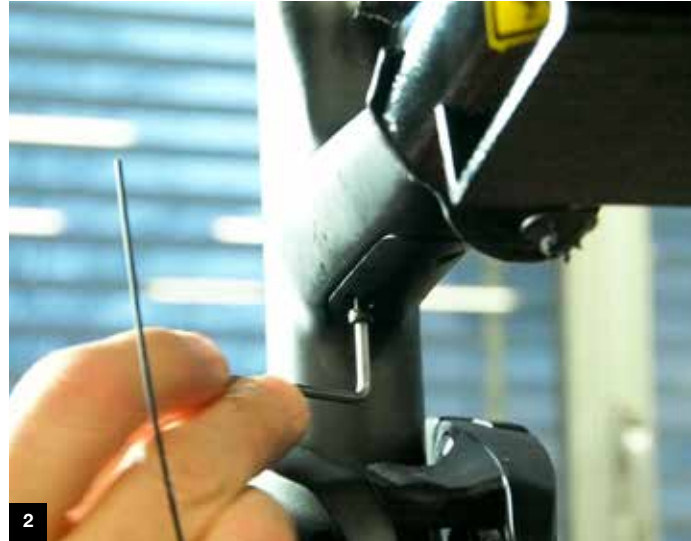

- 1 Remove the cable housing.
- 2 Loosen the screws of the lockbody cover and remove it.
- 3 Loosen the three lock body screws.
- 4 Remove the Lockbody by pushing it slightly back.



5 Accurately clean the lockbody, the pin and the spring.

6 Grease and re-assemble the pin.



7 Assemble a derailleur cable with the pin and spring in the Lockbody. The parts need to be greased well.



8 Install a new derailleur casing in the top tube.

Install end caps.

The cable housing needs to be cut to length (depending on frame size) before installation.

9

Cable housing cut length:

Small 650b	860 mm
Medium 650b	890 mm
Medium 29"	900 mm
Large 29"	920 mm
X-Large 29"	940 mm

10

Push the inner cable in the casing.
Don't push it through completely yet.





11 Lower the seatpost 1-3 mm while bringing the Lockbody into position.

12 The Lockbody will latch into the nut of the seatpost.

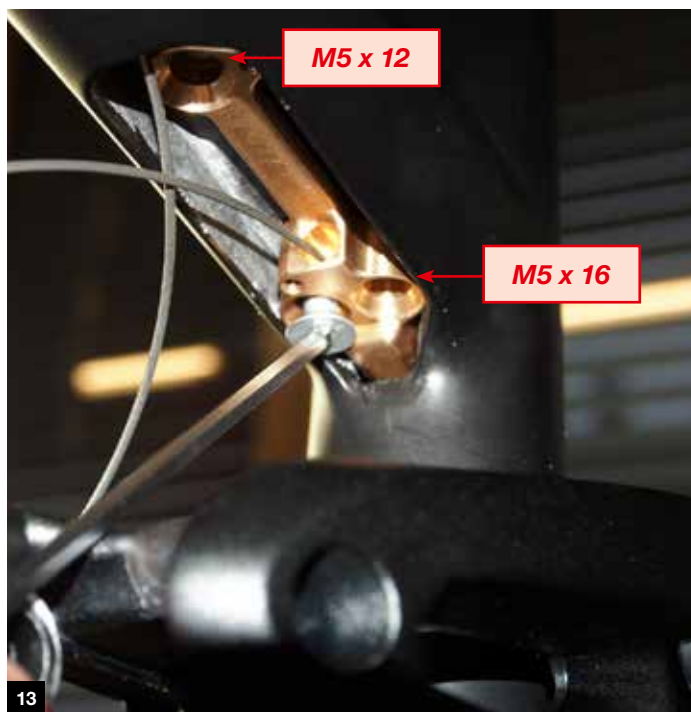

13 Fix the Lockbody with the 3 screws (coat with threadlocker).

Gradually tighten the screws alternating: 2Nm > 4Nm > 6Nm.

Final torque: 6Nm.

Notice:
The short screw is installed in the fore thread.



14



14 Pull cable through casing.

Push the casing in the Lockbody.



15



16

15 Install the Lockbody cover.

The screws need to be greased.

Notice:
The screws need to be greased.

16 Push it to the rear while tightening the screws.

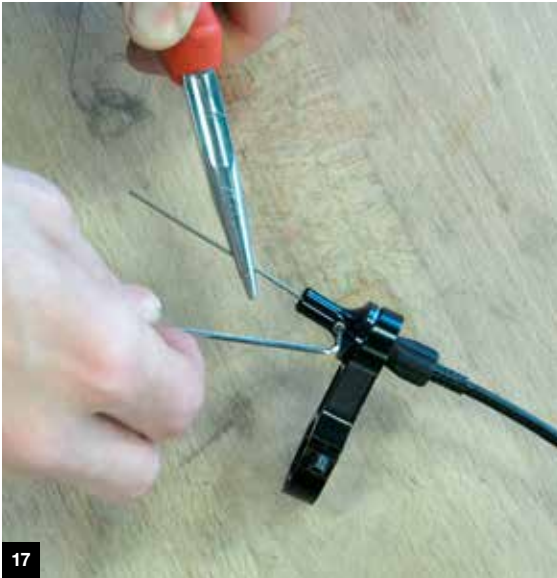

17



18

17 Pull on the cable while the lever base sits firm on the remote lever body.

Tighten the grub screw.

18 Cut off the cable ~10mm after the lever base.



19



19 Connect the lever with the base by sliding it over the cable.